

Características | Especificaciones



Material Material	Gresanit®
Aplicação Fijación	À Parede A la pared
Posicionamento do Pio Posición del Cuba	Central Al centro
Faces Vidradas Superficies Vidriadas	Visíveis Mostradas
	Todas Totalidad
Garantia Garantía	10 years 

Dimensões | Dimensiones (mm)

W	665
KG	19
L	570
H	240

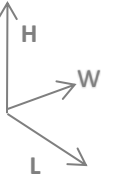

Componentes | Componentes

Incluído Incluido	Z-1	55081031	Tampa p/ Overflow Cromado Tapa p/ Overflow Cromo
Necessário Requerido	Coluna (se aplicável - consultar) Columna (si corresponde - consultar)		
	Torneira Grifo		
	Válvula de descarga Válvula de descarga		
	Sifão Sifón		

Desenho Técnico | Diseño Técnico

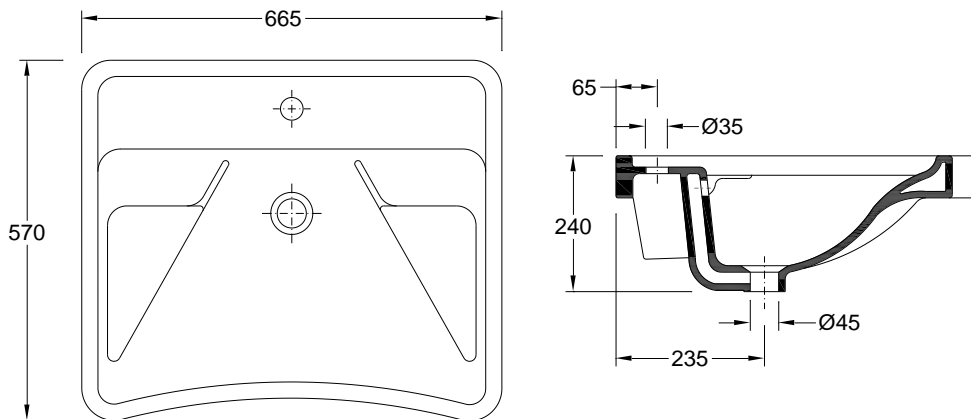

Recomendações | Recomendaciones!

Material Material	Tipo de Peça Tipo de pieza	Detergentes Detergentes		Material de Limpeza Material de Limpieza		Outras Recomendações Otras recomendaciones
		⊗	⊕	⊗	⊕	Atenção / Atención
Cerâmicos Cerámicos		Abrasivos Abrasivos	Ácidos e Bases fracas Sabão Neutro Ácidos y bases débiles Jabón Neutro	⊗	⊕	 Evitar deixar cobertos Evite dejar cubiertos
Metálicos Metálicos		Ácidos e Bases Acetona Álcool Amônia Abrasivos	Sabão Neutro Jabón Neutro	Abrasivos Abrasivos	Pano Suave Paño suave	 Não se colocar na superfície da tampa No se poner sobre la superficie superior
Plásticos/Resinas Plástica/Resinas		Ácidos e Bases Acetona Álcool Amônia Abrasivos				 Não forçar a deslida soft-close No forzar el deslido de la tapa suavizada

- PT - Outras recomendações mais específicas podem acompanhar os produtos comercializadas. Recomendamos que siga as recomendações e instruções indicadas.
EN - Other particular recommendations can be attached complementarily with the traded products. We strongly advise you to follow the recommendations and instructions indicated.

Specifications | Spécifications



Material Matériel	Gresanit®
Appliance Application	To the wall Au Mur
Sink Position Positionnement de l'évier	Centered Centré
Glazed Surfaces Surfaces vitrées	Visible Visibles Entirely Toutes
Warranty Garantie	10 years 

Dimensions | Dimensions (mm)

W	665
KG	19
L	570
H	240

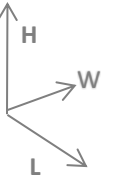







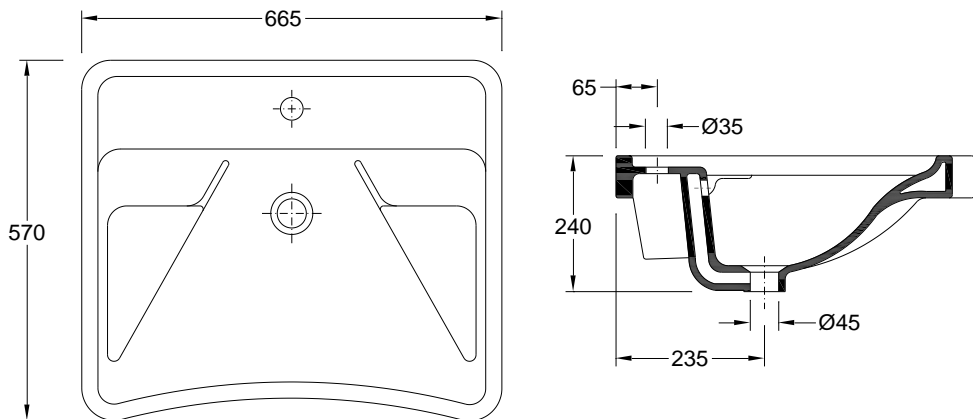

Components | Composants

Included Inclus	Overflow Cover Chrome Bouchon Chromé pour Troplein
Required Nécessaire	Pedestal (if applicable - check) Colonne (le cas échéant - consulter)
	Tap Robinet
	Discharge valve Bonde d'évacuation
	Siphon Siphon

Technical Drawing | Dessin technique



Recommendations | Recommandations!

Material Matériaux	Type of product Type de pièce	Detergents Détergents		Cleaning kit Matériel de Nettoyage		Other Recommendations Autres Recommandations
		⊗	✓	⊗	✓	
Ceramics Céramique		Abrasives Abrasifs	Acid and basic weak Neutral Soap Acides et bases Tapis Savon Neutre	⊗	✓	Attention / Attention  No dropping objects Évitez de faire tomber des objets
Metallics Métallique		Acid and Basic Acetone Alcohol Ammonia Abrasives	Neutral Soap Savon Neutre	Abrasives Abrasifs	Cleaning Cloth Chiffon doux	 Weight on cover Ne vous tenez pas sur la surface supérieure  Effort on soft-close Ne forcez pas la descente en douceur
Plastics/Resins Plastiques/Résines		Acid and Basic Acetone Alcohol Ammoniac Abrasifs				

- PT - Outras recomendações mais específicas podem acompanhar os produtos comercializados. Recomendamos que siga as recomendações e instruções indicadas.
EN - Other particular recommendations can be attached complementarily with the traded products. We strongly advise you to follow the recommendations and instructions indicated.